

Courses and Dist
Down Chest Creek

No. Course D.

1 N 50° W 34

2 N 3° W 28

3 N 65° E 46

4 N 34° E 34

5 N 82° E 11

6 North 18

7 N 63° W 38

209 Perches

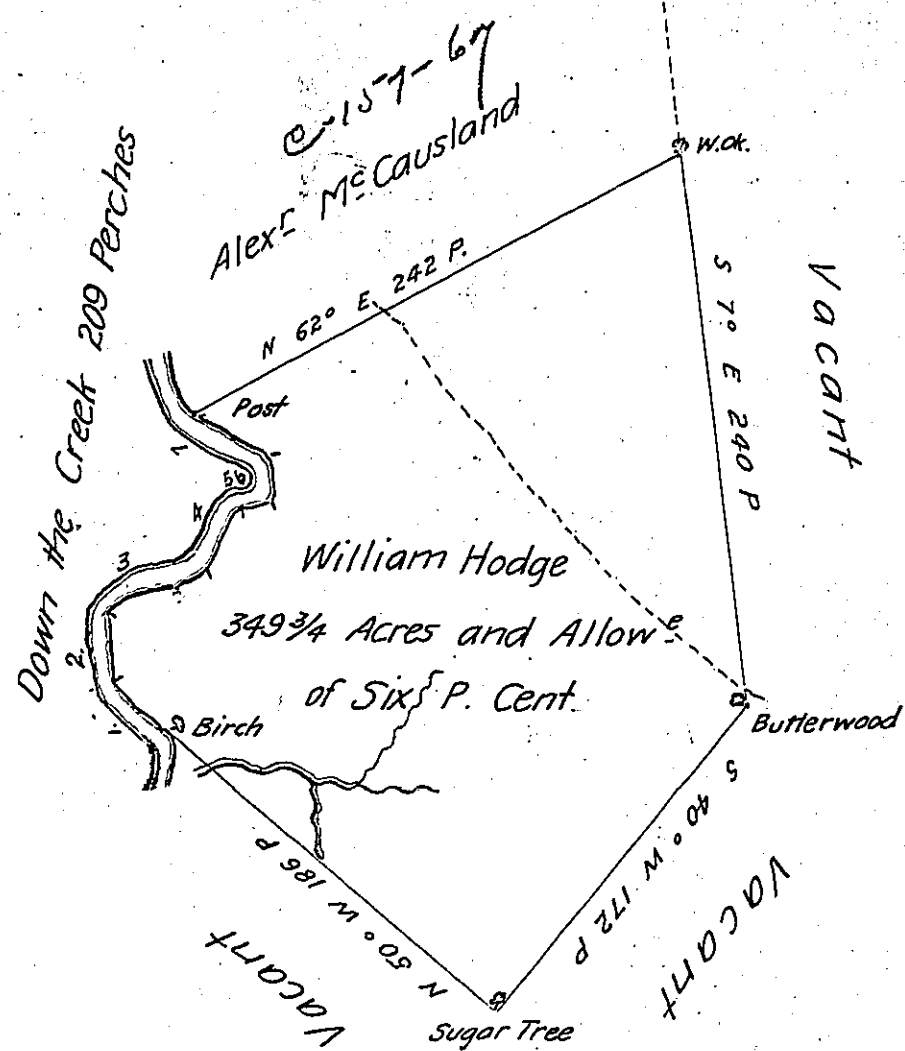

The above is the Draught of a Tract of Land, Called Hickory-Bank, Situate on the Chest Creek, on both sides; but mostly above, the old Trading-Path, adjoining and above Land surveyed for Alexander McCausland in Cumberland-County: Containing three hundred and forty-nine acres and Three Quarters, and the Usual Allowance of Six P. Cent for Roads &c. Surveyed the 3^d day of July 1769 for William Hodge in Pursuance of an Order No 1720 dated the 3^d day of April 1769

P-

Thomas Smith D.S.

To John Lukens Esq^r

Surveyor General.

IN TESTIMONY that the above is a copy of the original remaining on file in the Department of Internal Affairs of Pennsylvania, made conformably to an Act of Assembly approved the 16th day of February, 1833, I have hereunto set my Hand and caused the Seal of said Department to be affixed at Harrisburg, this seventh day of April 1905

Isaac P. Pearson
Secretary of Internal Affairs.